

**T8 tube fixture modification sketch map(how to take off the starter & ballast):**

1. Open the lamp fixture, cut out the 2pcs wires of lamp holder as below picture shown:

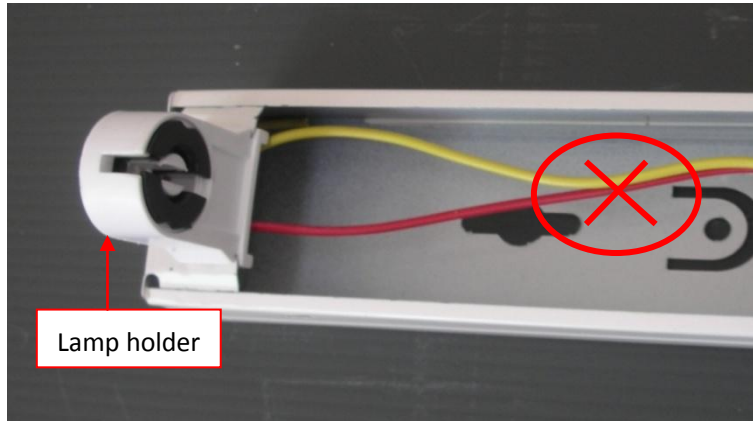

2. Carry on the same operation on the other side of the lamp fixture.

3. Joint any branch wire of the input cable (neutral wire or live wire is OK)with the 2pcs wires cut :

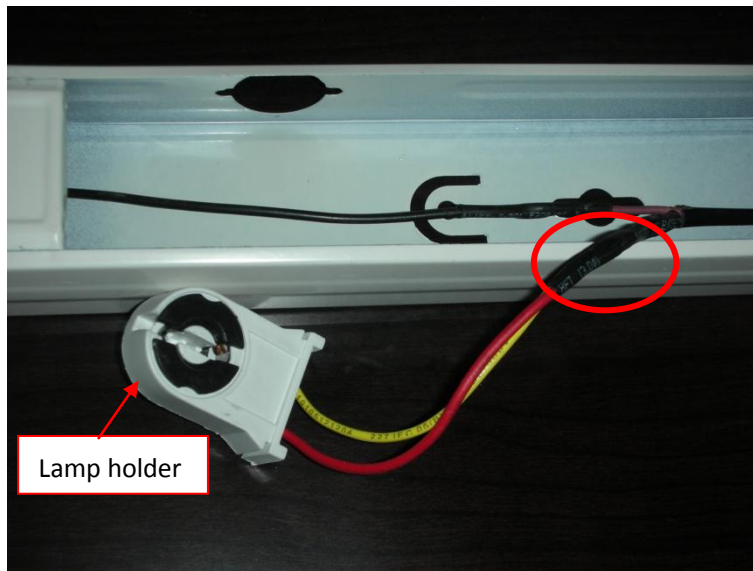

4. Joint the other wire of the input cable with the 2pcs wires of the opposite lamp holder.

The finished wire connection as below picture shown.

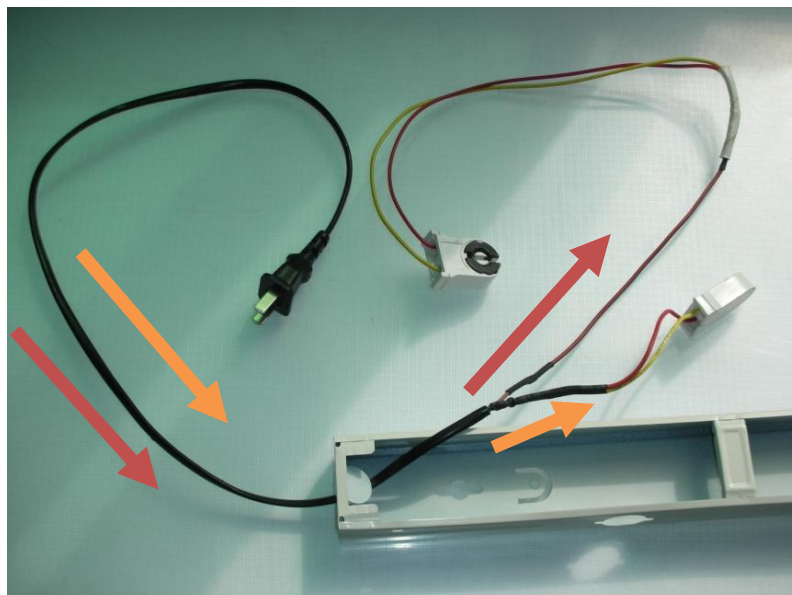

5. Put the lamp holders back to the lamp fixture, then remove the waste parts like starter、ballast and the un-connected wires.

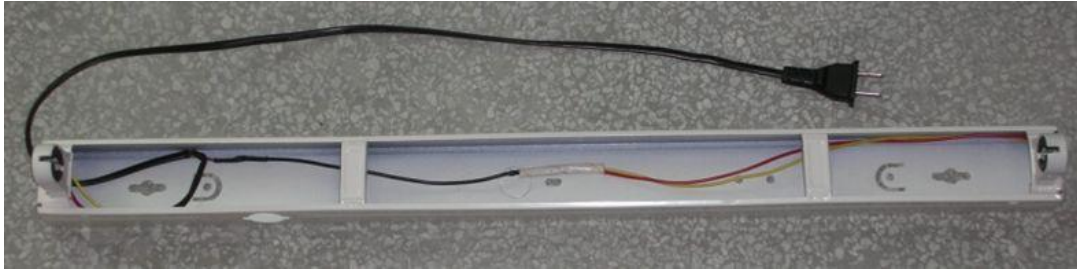

6. Put the cover back to the lamp fixture, then install the T8 tube for application.



**Taipei Office: 7F. No.15, Lane 427, Fu Shing N.Rd., Taipei Zip code:105**

**Tel: +886-2-25460395**

**Fax: +886-2-87707036**

**Shenzhen Office: Rm 904, Block East, Coastal City, Hai De 3rdRoad, Nan Shan District,  
ShenZhen City. China**

**Zip code 518054**

**Tel: +86-755-83201870**

**Fax: +86-755-83201877**

**HK Office: Rm C, 17/FI., Yun Kei Commercial Bldg., 682 Shanghai Street,Kowloon, Hong Kong**

**Tel: +852-23802800 23803600**

**Fax: +852-23977766**

**<http://www.energy-bright.com>**

**Email: [info@energy-bright.com](mailto:info@energy-bright.com)**